

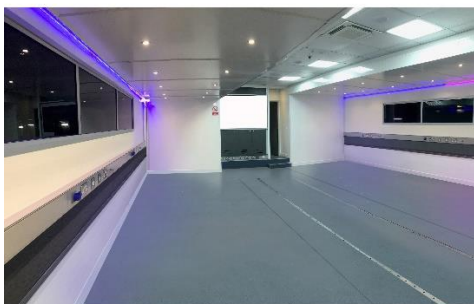

Titan 55 Specification Sheet



Titan 55 is a flexible medical/marketing unit which can be fully deployed in 1 hour. This unit has two hydraulic pods and glass doors with a canopy and tail lift fitted to the rear. The unit has a built-in passenger lift at the front of the trailer. It has a large open area provided by the pods giving an extended interior footprint. The trailer has been refurbished to a very high standard.

Vehicle Features

- Hydraulic double podded trailer
- Built in passenger lift
- Kitchen area
- Air-conditioning
- Seating for up to 40 people
- 63amp mains supply
- Fitted generator
- 1 SES Unit Manager and 1 hour set up



Titan 55 Specification Sheet

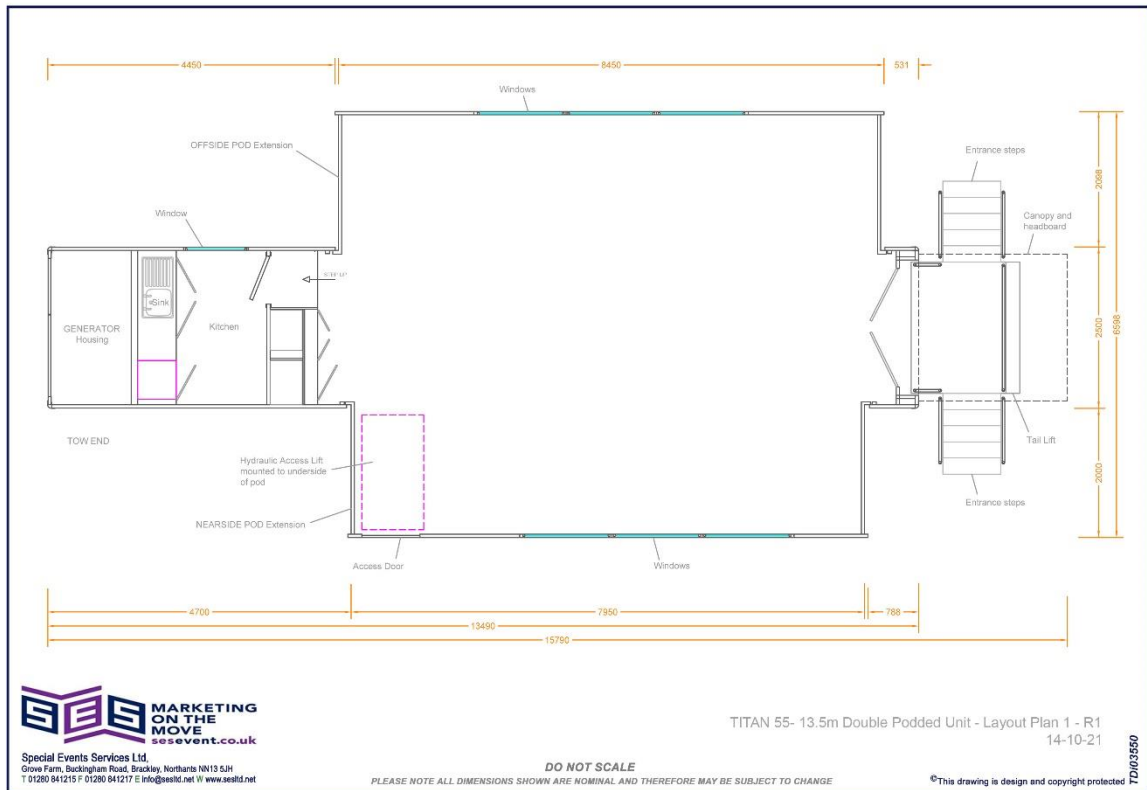

Size and Specifications

- Internal show space 55.0m²
- Internal Height in pod 2375mm
- Internal Height main body 2625m
- External Height 4m
- Flooring (Non-slip blue vinyl safety flooring)
- Internal wall finish Clean white gloss finished ready for branding
- External finish Clean White gloss finished ready for branding



